

1. 1 x Dampener stop
2. 1 x Hanger adaptor
3. 1 x Screw M4x16mm
4. 1 x Rubber pad

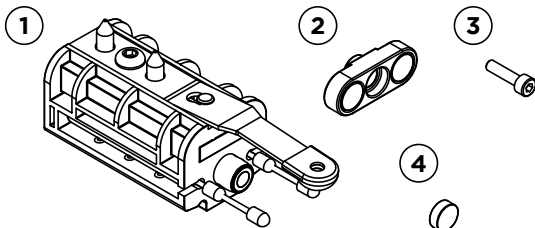

1. 1 x 3mm allen key
2. 1 x 4mm allen key
3. 1 x 5mm allen key

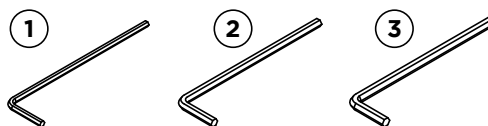

200-DS for systems up to 200kg
400-DS for systems up to 400kg

Ensure the correct orientation of the hanger

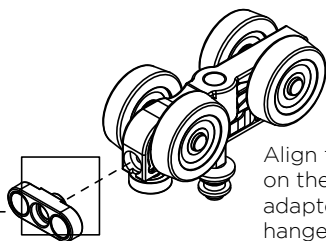
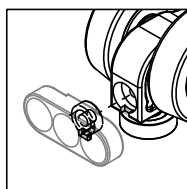
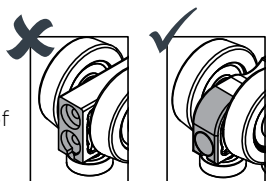

Align the key way on the hanger adaptor to the hanger. (Hanger and brackets sold separately)

Assemble the hanger adaptor to the hanger, using a 3mm Allen key and screw

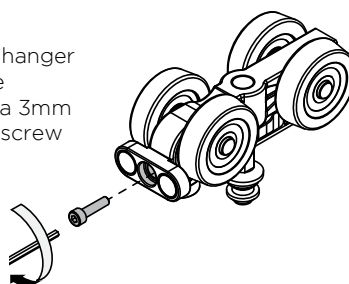

Cover fixing with rubber pad

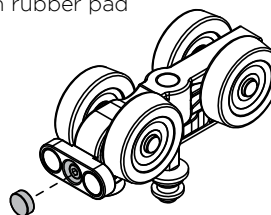

Hardware installation

Diagram illustrating the hardware installation of the damper stop:

- The main assembly shows a hanger with an adaptor being attached to a metal beam.
- The damper stop is shown being attached to the end of the beam.
- Two inset diagrams show the correct orientation of the hanger with the adaptor, ensuring the damper stop is properly aligned.

Side elevation shown with dampener stops used on both ends

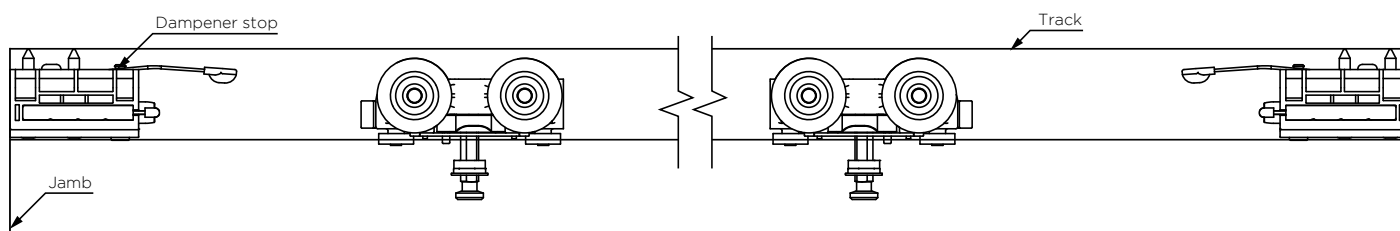

3. Attach panel to hanger

Carefully attach the panel and bracket to the hanger.

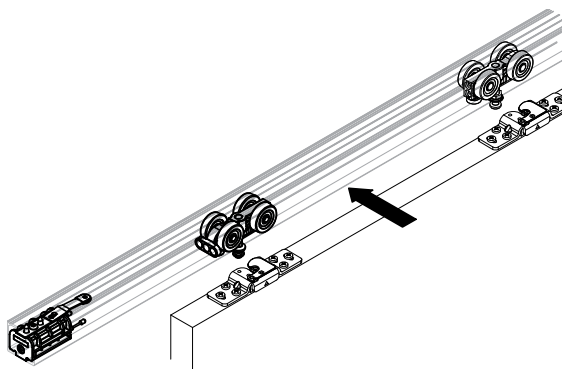

Note: Refer to relevant hanger and bracket instructions for further details

4. Dampener stop adjustment

Calculate the position of the dampener stop based on the formula **X (distance between jamb and dampener stop) = Y - 135mm**

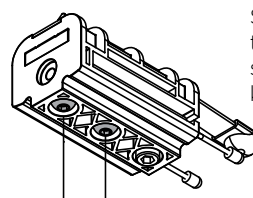
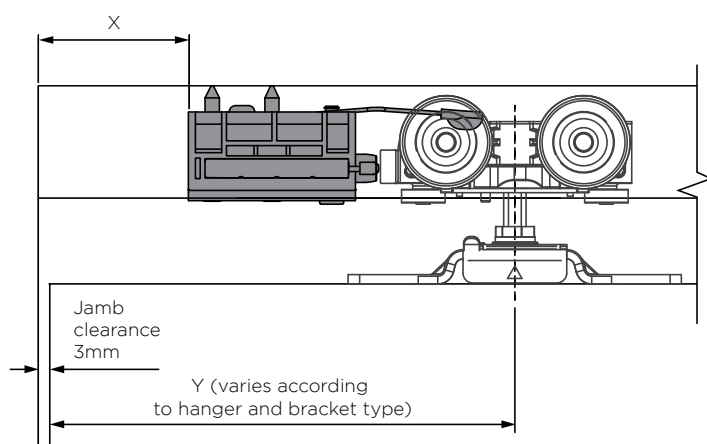

Screws for fixing the dampener stop, 4mm Allen key is needed

To adjust the dampener stop loosen the 2 outer screws using a 4mm allen key, move the dampener to desired position

Examples below:

Hanger and bracket: 57SS/MN

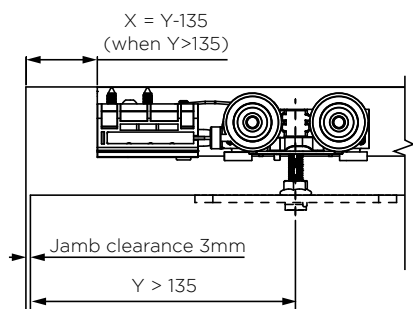

Hanger and bracket: 52SS/M

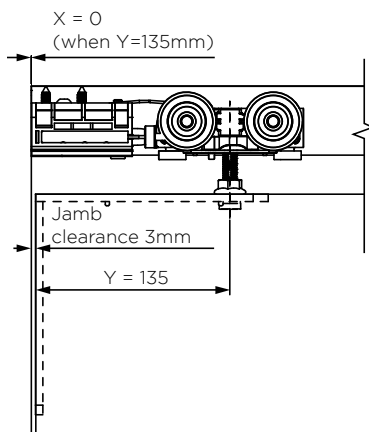

Hanger and bracket: 52SS/M

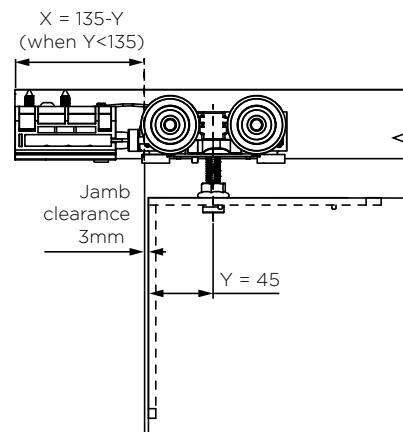

Note: Please refer to the specific hanger and bracket instructions for further details

5. Clamp force adjustment

To adjust the clamping force, tighten or loosen the screw to increase or decrease the clamping force, as shown below

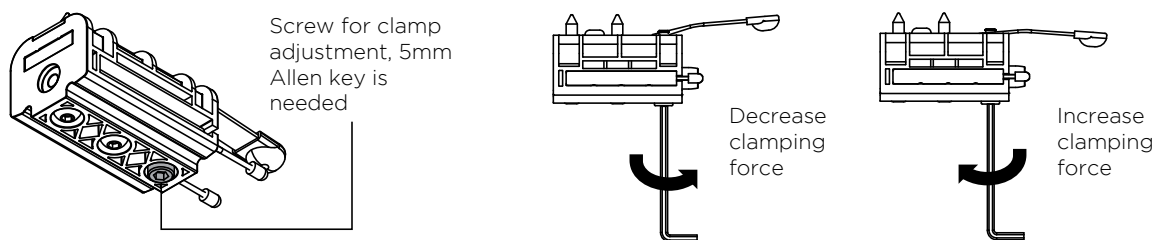

Overview

Below image is based on 57M hanger and bracket, for other bracket and soft close options, refer to their specific instructions

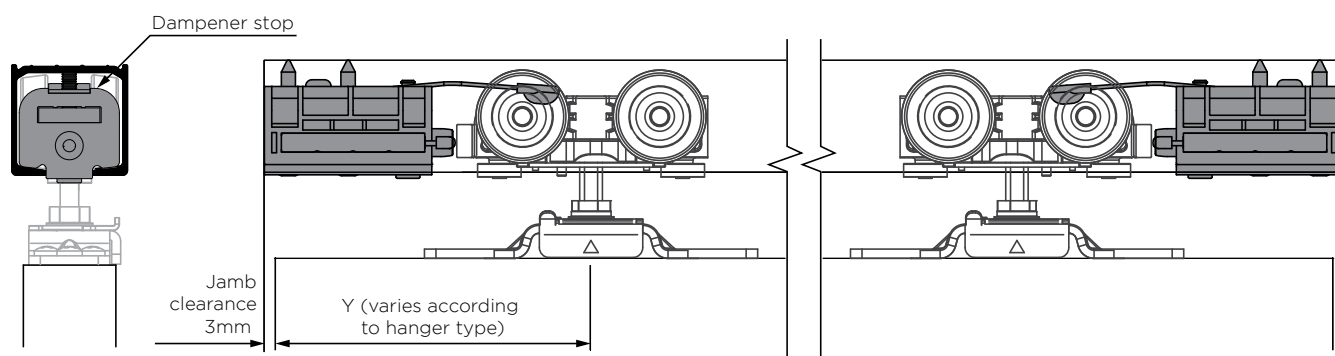

Care and maintenance

General

Inspect all fixing bolts for tightness every six months, including those securing brackets. Tighten if necessary. Routinely check for wear and if excessively worn, the part should be replaced.

To help prevent surface corrosion, wash regularly with soap or mild detergent and warm water followed by rinsing with clean cold water and dry.

Track

Keep track free from obstruction and excessive dirt or water. Visible surfaces should be cleaned using a damp cloth and mild detergent, then wiped dry.

Hangers

All hangers are fitted with lubricated ball-bearings, requiring no greasing. If doors 'settle' and door clearance is reduced causing friction, raise the door by the hanger adjustment nuts. Wash as per the above recommendation and apply a light application of corrosion preventative to all surfaces, using a dry cloth to remove excess.

Guides

Guide roller and guide channel must be kept clear and free of obstructions. Wash as per the above recommendation and apply a light application of corrosion preventative to all surfaces, using a dry cloth to remove excess.



ALLEGION™

Brio Australia
1800 098 094
info.au@allegion.com
www.brio.com.au

Brio NZ
+64 9 829 0550
nzinfo@allegion.com
www.brionz.com